



HP PageWide XL 5000 Printer series

Powerful, efficient monochrome and color production with up to 30% savings in total production costs¹



LEAD

Fast delivery times in monochrome and color

- Up to 14 A1/D pages/minute print speed, quick 30-second first page out
- Deliver mixed monochrome and color sets in 50% of the time with a consolidated workflow²
- Start printing in 50% of the time³—an ultra-fast processor, native PDF management, HP SmartStream software
- Free up the operator—production stacker/online folder,⁴ up to 4 rolls, dual ink supplies with auto-switch

GROW

Fast color, excellent document quality

- Generate new business growth—print GIS map, point-of-sale (POS) poster applications at breakthrough speeds
- Set a new technical document standard with crisp lines, fine detail, and smooth grayscales that beat LED⁵
- HP PageWide XL pigment ink for dark blacks, vivid colors, moisture/fade resistance—even on uncoated bond⁶
- Print on a wide range of media up to 101.6 cm/40 inches—covering ISO/US technical and offset standards⁷

SAVE

Cut total production costs up to 30%¹

- Print monochrome and color technical documents at the same or lower cost than comparable LED printers⁸
- Do it all with one space-saving device for both monochrome and color, or opt for the MFP to print/scan/copy
- Cut job preparation and finishing costs up to 50%²
- See up to 5 times lower energy consumption than comparable LED printers⁹

For more information, please visit
hp.com/go/pagewidexl/5000series



reddot award 2016
best of the best



¹ Production costs savings based on an HP PageWide XL 5000 Printer compared with a combination of a mid-volume monochrome LED printer and a mid-volume color production printer (both under \$40,000 USD) as of April, 2015. Production costs consist of supplies and service costs, printer energy costs, and operator costs. For testing criteria, see hp.com/go/pagewidexlclaims.

² Based on internal HP testing on the HP PageWide XL 5000 Printer compared to preparing and printing the job on two different printers (one comparable monochrome mid-volume LED printer for the monochrome pages and one color printer for the color pages). For testing criteria, see hp.com/go/pagewidexlclaims.

³ Using HP SmartStream software compared with using equivalent software programs. For testing criteria, see hp.com/go/pagewidexlclaims.

⁴ The HP PageWide XL folder is an optional accessory. The HP PageWide XL High-capacity Stacker may be an optional accessory. Options vary by region.

⁵ For output produced with HP PageWide XL printers and LED printers from different manufacturers and that represent greater than 50% of the annual shipments of LED printers in North America as of 2014 according to IDC. For testing criteria, see hp.com/go/pagewidexlclaims.

⁶ Compared to prints produced with HP 970/971/980 inks that are fade and moisture resistant per ISO 11798 Permanence and Durability Methods certification. For testing criteria, see hp.com/go/pagewidexlclaims.

⁷ ISO/US technical and offset standards include American ANSI and Architectural page size standards, ISO A technical document standard, and ISO B offset page size standard.

⁸ Based on supplies and service costs. Monochrome technical document printing costs for comparable mid-volume LED printers based on printers for large-format printing of technical documents at speeds between 8 and 13 D/A1 per minute as of April, 2015 which represent more than 80% of the share of mid-volume LED printers in the US and Europe in 2014 according to IDC. Color technical document printing costs for comparable mid-volume color printers based on printers capable of printing 4 D/A1 pages per minute or more and under \$50,000 USD for large-format printing of technical documents as of April, 2015 and representing more than 80% of the market in the US and Europe in 2014 according to IDC. For testing criteria, see hp.com/go/pagewidexlclaims.

⁹ Conclusions based on internal HP testing for a specific use scenario. Comparable printers using LED technology based on LED printers capable of printing 8 to 13 D/A1 pages per minute and which represent more than 80% of the share of mid-volume LED printers in the US and Europe according to IDC as of April, 2015. For testing criteria, see hp.com/go/pagewidexlclaims.

Beat record delivery with consolidated workflows—produce mixed monochrome and color sets in 50% of the time.² Achieve up to 30% savings in total production costs.¹ Save space and trim workflow cost with a single device for monochrome and color, or print/scan/copy with a multifunction printer.

HP PageWide Technology

The HP PageWide XL 5000 Printer series includes a stationary 101.6 cm/40 inches printbar that spans the whole printing width. As paper moves under the printbar, the entire page is printed in one pass, enabling very high printing speeds.



8 HP PageWide XL ink cartridges (2 x 400-ml per color with auto-switch)

HP PageWide XL pigment ink for HP PageWide XL printers

HP PageWide XL pigment ink is specially designed to provide reliable and dependable operation with HP PageWide XL printers and produce high-quality output:

- Dark blacks and vivid colors on a range of media including uncoated bond papers
- Moisture- and fade-resistant prints⁶

Proven technology for reliable operation

Designed for mid-volume production, the HP PageWide XL 5000 Printer series is based on proven HP PageWide Technology, currently powering HP PageWide Web Presses—producing 4 billion impressions monthly—and HP X series business printers.

HP 841 PageWide XL Printheads provide reliable and long-life operation, with an average life per printhead of 32 liters of ink.

Save time and reduce complexity by consolidating your monochrome and color workflows

Get away from the complex and lengthy process in which color and monochrome pages must be manually separated by an operator, who must then send color and monochrome to two different printers, and then finally manually collate the color and monochrome pages together.

Now you can consolidate your workflow by delivering mixed monochrome and color sets that help to contribute to up to 30% savings in total production costs.¹ HP SmartStream software can help you improve your current technical production workflow efficiency for single, multiple operator environments by preparing your jobs in 50% of the time.³

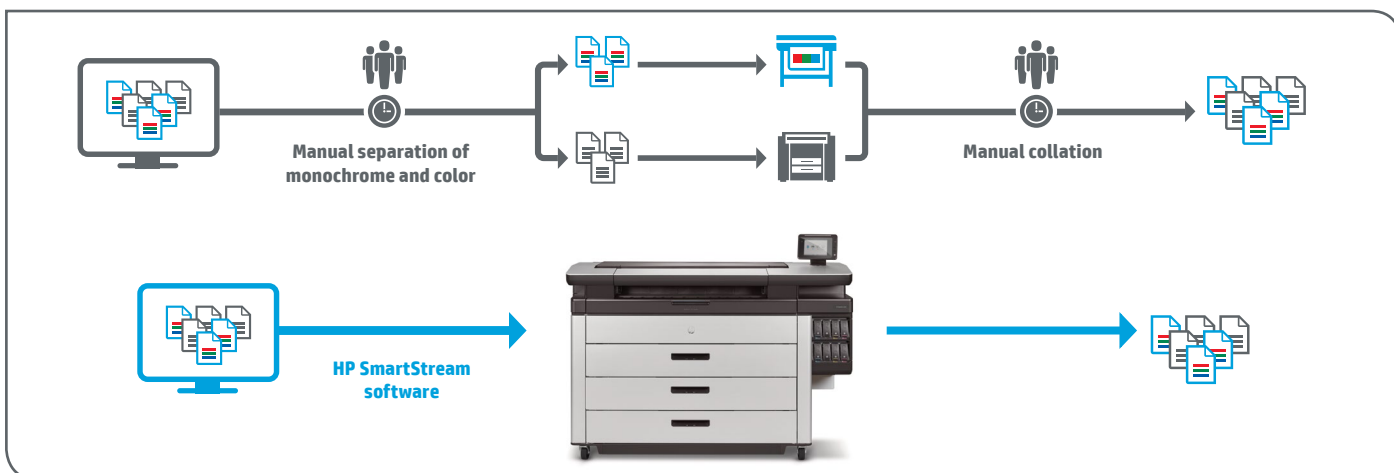

Print fast, deliver faster

1. Using HP SmartStream Preflight Manager, jobs can be prepared in 50% of the time³
2. With an ultra-fast processor and the embedded Adobe PDF Print Engine 3,¹⁰ HP PageWide XL printers are designed for quick processing, including the most complex jobs
3. Print up to 14 A1/D pages/minute in monochrome and color
4. Reduce the wait for short jobs with a quick, 30-second first page out

Set a new quality standard for technical documents

HP 841 PageWide XL Printheads, working with HP PageWide XL pigment ink, are designed to produce durable and high-quality output with dark blacks and vivid colors.

Accurate and reliable dot placement results in crisp lines, fine detail, and smooth grayscales. HP PageWide XL printers do not apply heat to the paper as part of the printing process, enabling very high levels of length accuracy ($\pm 0.1\%$).

Save space and trim workflow cost with a single device for monochrome and color, or print/scan/copy with a multifunction printer



1. **Up to 4 rolls**—automatic roll switching when a roll is depleted or a different page size is selected.
2. **Dual 400-ml HP ink supplies** with auto-switch—replace used cartridges while the printer is running.
3. **203-mm (8-inch) touchscreen**—status light reports current status and provides progressive alerts on potential issues that could impact production (i.e., out of paper or ink).
4. **Top stacker** designed to save space. With a capacity of up to 100 pages. Combine with the HP PageWide XL Folder or the HP PageWide XL High-capacity Stacker for second output path.⁴
5. **High-capacity** output solutions specially designed to keep up with HP PageWide XL print speeds (HP PageWide XL High-capacity Stacker and HP PageWide XL Folder).⁴

¹⁰ Adobe PDF Print Engine 3 is the next-generation rendering platform, optimized for end-to-end PDF workflows. Adobe PDF Print Engine 3 combines performance optimizations with a new scalability framework to power high-speed digital presses, large-format printers, and CTP platesetters. Adobe PDF Print Engine 3 is the fastest rendering platform for reliable reproduction of complex, graphically rich content. To learn more, visit adobe.com/products/pdfprintengine.

Technical specifications

General	Description	Large-format color MFP or printer	
	Technology	HP PageWide Technology	
	Applications	Line drawings, Maps, Orthophotos, Posters	
	Ink types	Pigment-based (cyan, magenta, yellow, black)	
	Ink cartridges	8 (2x 400-ml per color) with auto-switch	
	Printheads	8x HP 841 PageWide XL Printheads	
	Average printhead life	32 liters	
	Printhead warranty	10 liters or 12 months from installation	
	Print resolution	1200 x 1200 dpi	
	Minimum line width	0.02 mm (0.0008 in) (HP-GL/2 addressable)	
	Guaranteed minimum line width	0.085 mm (0.0033 in) (ISO/IEC 13660:2001(E)) ¹¹	
	Line accuracy	+/- 0.1% ¹²	
	Print speed	Maximum print speed	9 m/min (27.8 ft/min)
		A1/Arch D/ANSI D (long edge first)	14 pages/min, ¹³ 600 pages/h
		A0/Arch E/ANSI E (short edge first)	7 pages/min, 300 pages/h
ISO B1 (long edge first)		10 pages/min, 500 pages/h	
Warm-up time		No warm up	
First page out		30 sec. (from Ready mode)	
Media		Media rolls	2 rolls default with auto-switching, expandable to 4 rolls
		Roll width	279 to 1016 mm (11 to 40 in)
		Roll length	Up to 200 m (650 ft)
		Roll diameter	Up to 177 mm (7 in)
	Roll core diameter	7.6 cm (3 in)	
	Printable width	Up to 1000 mm (39.4 in)	
	Printable length	Up to 200 m (650 ft) for CAD and 30 m (98 ft) for poster ¹⁴	
	Media weight	70 to 200 g/m ² (19 to 53 lb)	
	Media thickness	Up to 0.4 mm (15.7 mil)	
	Media types	Bond and recycled papers, poster papers, polypropylene, tyvek, matte film	
	Media output (standard)	Basket	
	Media output (optional)	High-capacity stacker, ⁴ online folder, ⁴ top stacker	
	High-capacity stacker⁴	Maximum page size	102 x 122 cm (40 x 48 in) ¹⁵
		Capacity	Up to 500 pages
		Media weight	70 to 200 g/m ² (19 to 53 lb)
Dimensions		101 x 125 x 108 cm (55.6 x 49.1 x 42.6 in)	
Weight		140 kg (308 lb)	
Online folder⁴		Page width	28 to 91.4 cm (11 to 36 in)
		Page length	Cross fold: 2.5 m (8.2 ft) Fan fold: 6 m (19.7 ft) (standard), unlimited (optional with HP PageWide XL Folder Upgrade Kit for Long Plots)
		Media weight for folding	75 to 90 g/m ² (20 to 24 lb)
		Media weight for stacking	75 to 200 g/m ² (20 to 53 lb)
		Capacity	Up to 150 (A0)
	Dimensions	1626 x 1245 x 1842 mm (64 x 49 x 72.5 in) (1626 x 1245 x 2150 mm with Tab applicator (64 x 49 x 84.6 in))	
	Weight	310 kg (683 lb), (350 kg (772 lb) with Tab applicator)	
	Tab applicator	Available with HP PageWide XL Folder with Tab applicator only	
	Scanner	Description	36-in (91-cm) CIS scanner
		Speed	Color: up to 7.62 cm/sec (3 in/sec) at 200 dpi Grayscale: up to 25.4 cm/sec (10 in/sec) at 200 dpi
Optical resolution		1200 dpi	
Scan width		Up to 914 mm (36 in)	
Original thickness		Up to 0.26 mm (0.01 in)	
Maximum copy length		9512 mm (374.48 in)	
Maximum scan length		18000 mm (708.66 in) (TIFF, 24-in wide original at 200 dpi), 8000 mm (314.96 in) (JPEG), 5000 mm (196.85 in) (PDF)	
Scan format		Standard: JPEG, TIFF; optional: PDF 1.4, multi-page PDF 1.4 (with PS/PDF upgrade)	
Scan features		Preview with cropping, scan quicksets, batch scanning	
Scan destination		USB, network folder (SMB), scan to email, scan to HP SmartStream software	
Embedded controller	Processor	Intel Core i3	
	Memory	8 GB DDR3	
	Hard drive	1x 500 GB HDD, self-encrypted with AES-256	
	Print languages (standard)	HP-GL/2, PCL 3 Win	
	Print languages (optional)	Adobe PostScript 3, Adobe PDF 1.7, TIFF, JPEG (with PS/PDF upgrade)	
Connectivity	Remote management	HP Partner Link, HP Embedded Web Server, HP Web Jetadmin	
	Interfaces	TCP/IP, BootP/DHCP, USB 2.0 host (certified)	
	Printing paths	HP SmartStream software (optional) HP Universal Print Driver (HP-GL/2 and PS) HP PageWide XL print drivers (PDF, HP-GL/2, and PS)	
User interface	User interface	203-mm (8-inch) capacitive touchscreen	

¹¹ Measured on HP Universal Bond Paper.
¹² +/-0.1% of the specified vector length or +/-0.2 mm (whichever greater) at 23°C (73°F), 50-60% relative humidity, on A0/E printing material in Best or Normal mode with HP Matte Polypropylene and Original HP inks.
¹³ Print speed while printing to the HP PageWide XL High-capacity Stacker. When printing to the top stacker, the maximum print speed is 12 pages/minute.
¹⁴ For longer plots (up to 200 m (656 ft)), image quality might be affected.
¹⁵ Long plots with reduced capacity.
¹⁶ BMG trademark license code FSC®-C115319, see fsc.org. HP trademark license code FSC®-C017543, see fsc.org. Not all FSC®-certified products are available in all regions. For information about HP large format printing materials, please visit HPLFMedia.com.

Dimensions (w x d x h)	Printer	1960 x 800 x 1303 mm (77.2 x 31.5 x 51.3 in)
	MFP	1960 x 864 x 1303 mm (77.2 x 34 x 51.3 in) Depth: 800 x 64 mm removable scanner input tray to pass through doorways (31.5 x 2.5 in)
Weight	Shipping	2180 x 1068 x 1764 mm (86.8 x 42.1 x 69.5 in)
	Printer	430 kg (948 lb)
Environmental	Shipping	521 kg (1148 lb)
	Operating temperature	5 to 40°C (41 to 104°F)
Acoustic	Recommended temperature	15 to 35°C (59 to 95°F)
	Operating humidity	20 to 80% RH, depending on media type
Power	Sound pressure	53 dB(A) (printing), 35 dB(A) (ready), <24 dB(A) (sleep)
	Sound power	7.1 B(A) (printing), 5.2 B(A) (ready), 4.2 B(A) (sleep)
Certification	Consumption	0.46 kW (typical); 0.8 kW (max printing); 108.4 watts (ready); < 1 watts (< 4.6 watts with embedded Digital Front End) (sleep)
	Requirements	Input voltage (auto ranging) 100-127/200-240 ± 10% VAC, 50/60 ± 3 Hz, 10/5 A
Warranty	Safety	IEC 60950-1+A1+A2 compliant; USA and Canada (CSA listed); EU (LVD and EN 60950-1 compliant); Russia, Belarus, and Kazakhstan (EAC)
	Electromagnetic	Compliant with Class A requirements, including: USA (FCC rules), Canada (ICES), EU (EMC Directive), Australia and New Zealand (RCM), Japan (VCCI), Korea (KC)
Original HP large format printing materials	Environmental	ENERGY STAR, EPEAT Silver, CE marking (including RoHS, WEEE, REACH). In compliance with WW RoHS materials restriction requirements in China, Korea, India, Vietnam, Turkey, Serbia, and Ukraine.
	Warranty	90 days

Ordering information

Product	CZ310A	HP PageWide XL 5000 40-in Printer
	CZ311A	HP PageWide XL 5000 40-in Multifunction Printer
Accessories	CZ317A	HP PageWide XL PostScript/PDF Upgrade Kit
	CZ318A	HP PageWide XL Drawer
	CZ319A	HP PageWide XL High-capacity Stacker ⁴
	CZ320A	HP PageWide XL Top Stacker
	G6H50B	HP SD 44-in Pro Scanner
	G6H51B	HP HD 42-in Pro Scanner
	K5H75A	HP PageWide XL Folder
	L3J69AAE	HP SmartStream Preflight Manager
	L3J71AAE	HP SmartStream Preflight Manager One-Year Subscription
	L3J74AAE	HP SmartStream Print Controller for HP PageWide XL 5000 Printer series
	L3M58A	HP PageWide XL Folder with Tab Applicator
	MOV04A	HP PageWide XL Folder Upgrade Kit for Long Plots
Original HP PageWide XL printheads and consumables	C1Q19A	HP 841 PageWide XL Printhead
	F9J47A	HP 841 PageWide XL Cleaning Container
	F9J48A	HP 841 PageWide XL Maintenance Cartridge
Original HP PageWide XL ink cartridges	C1Q65A	HP 843C 400-ml Black PageWide XL Ink Cartridge
	C1Q66A	HP 843C 400-ml Cyan PageWide XL Ink Cartridge
	C1Q67A	HP 843C 400-ml Magenta PageWide XL Ink Cartridge
	C1Q68A	HP 843C 400-ml Yellow PageWide XL Ink Cartridge
Original HP large format printing materials	L4L08A	HP Universal Bond Paper, 3-in Core (FSC® certified) ¹⁶ 914 mm x 152.4 m (36 in x 500 ft)
	L5P98A	HP Production Matte Poster Paper, 3-in Core (FSC® certified) ¹⁶ 1016 mm x 91.4 m (40 in x 300 ft)
	L5Q03A	HP Production Satin Poster Paper, 3-in Core (FSC® certified) ¹⁶ 1016 mm x 91.4 m (40 in x 300 ft)
	L5C80A	HP Universal Heavyweight Coated Paper, 3-in Core (FSC® certified) ¹⁶ 914 mm x 91.4 m (36 in x 300 ft)
	L6B19A	HP Matte Polypropylene, 3-in Core 1016 mm x 45.7 m (40 in x 150 ft)

Enjoy best-in-class support services, knowing HP works with HP PageWide XL Channel Partners to enable them to be properly trained, certified, and equipped to meet your needs. With efficient support and innovative support features, such as printer self-monitoring, predefined resolution paths, and intuitive maintenance wizards, you can work with confidence every day. For more information, please visit hp.com/go/pagewidexservice.

HP Financial Services can help you acquire an HP PageWide XL printing solution and accelerate the benefits to your business. Our solutions can help you increase your flexibility by preserving cash, freeing up budgets with a monthly payment structure, and offering an easy option to upgrade to the latest model when your business is ready. For more information, please visit hp.com/hpfinancialservices.

Find the media solution that fits your business and your HP PageWide XL printer at hp.com/go/mediasolutionslocator

Eco Highlights

- Save paper with automatic print settings and image nesting
- ENERGY STAR® certified and EPEAT Silver registered¹
- Free, convenient HP ink cartridge recycling²
- FSC®-certified papers,³ range of recyclable HP media⁴

¹ EPEAT registered where applicable and/or supported. See epeat.net for registration status and rating by country.
² Program availability varies. Please check hp.com/recycle for details.
³ BMG trademark license code FSC®-C115319, see fsc.org. HP trademark license code FSC®-C017543, see fsc.org. Not all FSC®-certified products are available in all regions. For information about HP large format printing materials, please visit HPLFMedia.com.
⁴ Can be recycled through commonly available recycling programs.

Please recycle large-format printing hardware and printing supplies.
Find out how at our website hp.com/ecosolutions

